

Graphic Documentation

1. Illustrating case studies of physical, visual and territorial boundaries in NYC/BCN. Collective structure.

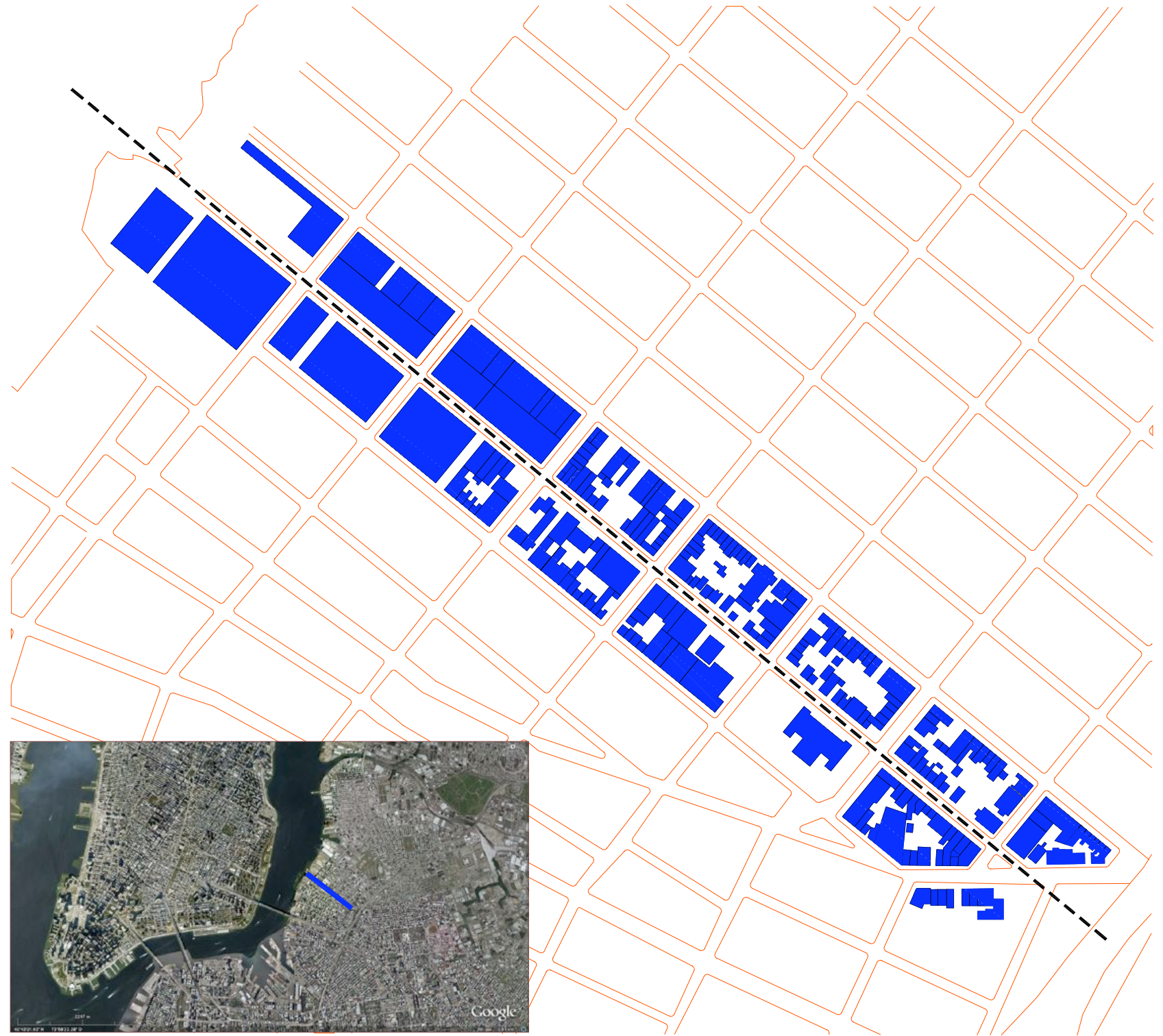

Kris Scheerlinck, doctoral candidate
 Universitat Ramon Llull, E.T.S.A. La Salle
 Barcelona, Spain, 2009-2010
Depth Configurations
 Proximity, Permeability and Territorial Boundaries in Urban Projects

- axe sequence
- building perimeter
- traffic systems

Illustrating Case Study: Williamsburgh, New York City, U.S.A.
 Site: North 5th Street

Situation map
 base: in situ photographs & mapping

north ↑
 scale: 1/5000

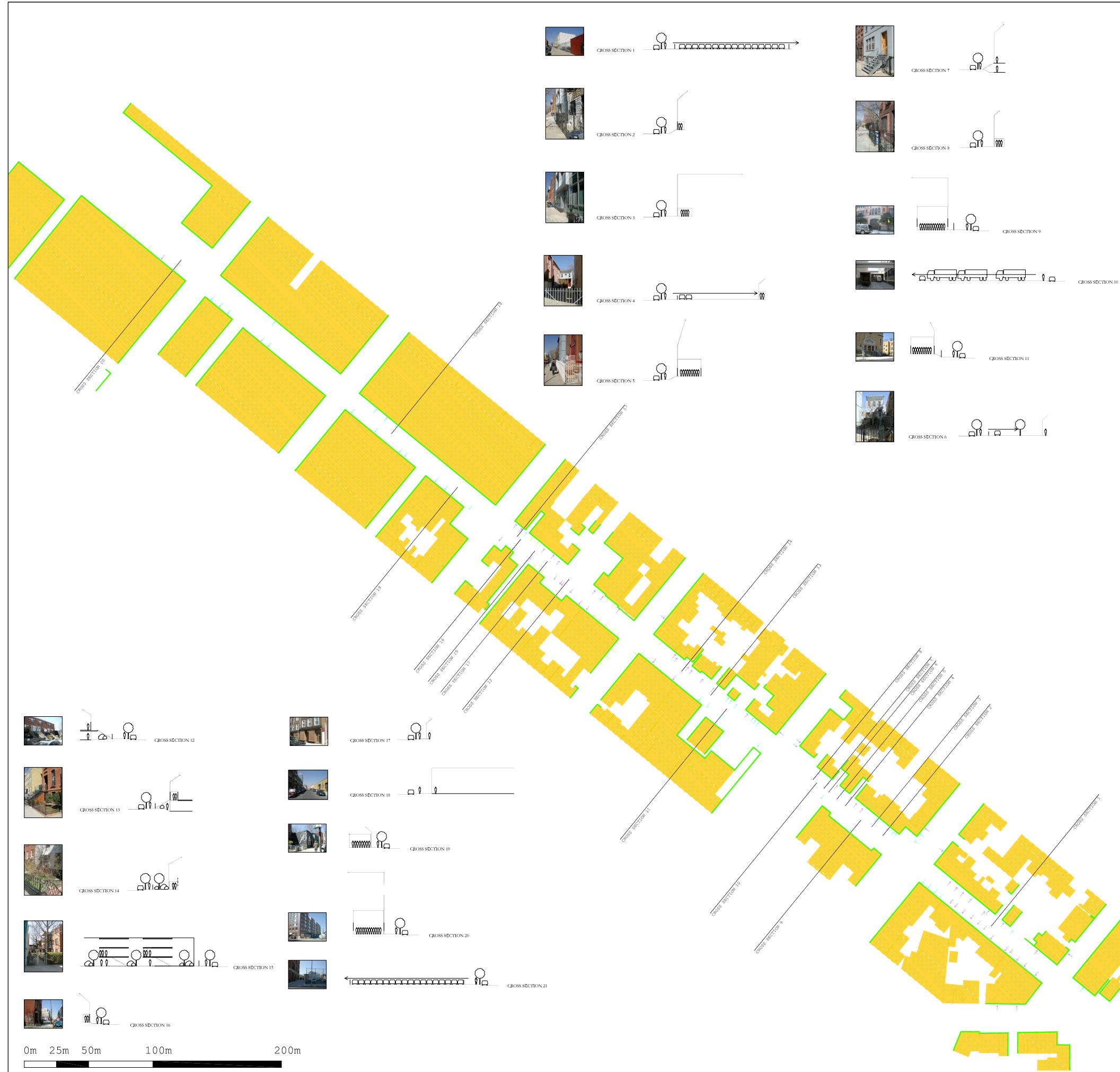

Kris Scheerlinck, doctoral candidate
 Universitat Ramon Llull, E.T.S.A. La Salle
 Barcelona, Spain, 2009-2010
Depth Configurations
 Proximity, Permeability and Territorial Boundaries in Urban Projects

- built space
- boundary limit: filters
- housing entrance
- commercial entrance
- service/facility entrance
- garden entrance
- warehouse/industry entrance

Illustrating Case Study: Williamsburgh, New York City, U.S.A.
 Site: North 5th Street
Street alignment and cross sections
 base: in situ photographs & mapping

north
 scale: graphic

CROSS SECTION 1

ACTIVITY

OPEN SPACE - BUILT SPACE
 NO RESTRICTED ACCESS - EXCLUSIVE ACCESS
 RESTRICTED ACCESS - EXCLUSIVE ACCESS
 DIFFERENTIAL COLLECTIVE SPACE
 VISUAL ACCESS

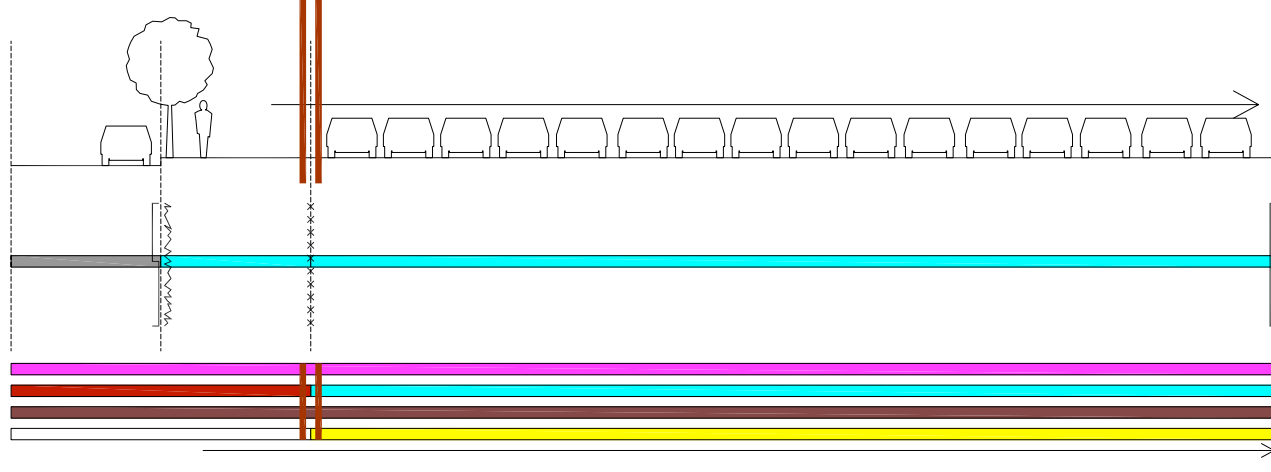

CROSS SECTION 2

ACTIVITY

OPEN SPACE - BUILT SPACE
 NO RESTRICTED ACCESS - EXCLUSIVE ACCESS
 RESTRICTED ACCESS - EXCLUSIVE ACCESS
 DIFFERENTIAL COLLECTIVE SPACE
 VISUAL ACCESS

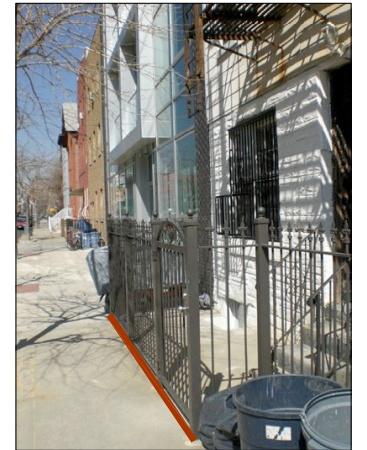
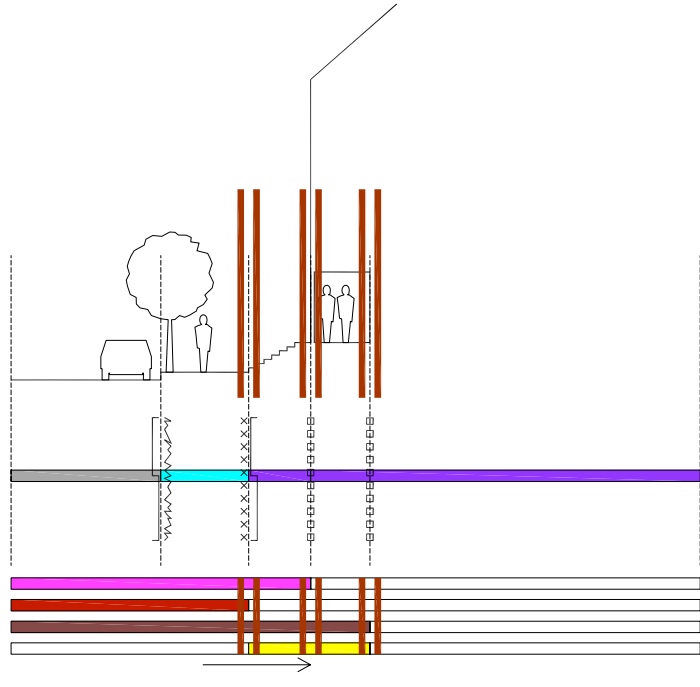

CROSS SECTION 3

ACTIVITY

OPEN SPACE - BUILT SPACE
 NO RESTRICTED ACCESS - EXCLUSIVE ACCESS
 RESTRICTED ACCESS - EXCLUSIVE ACCESS
 DIFFERENTIAL COLLECTIVE SPACE
 VISUAL ACCESS

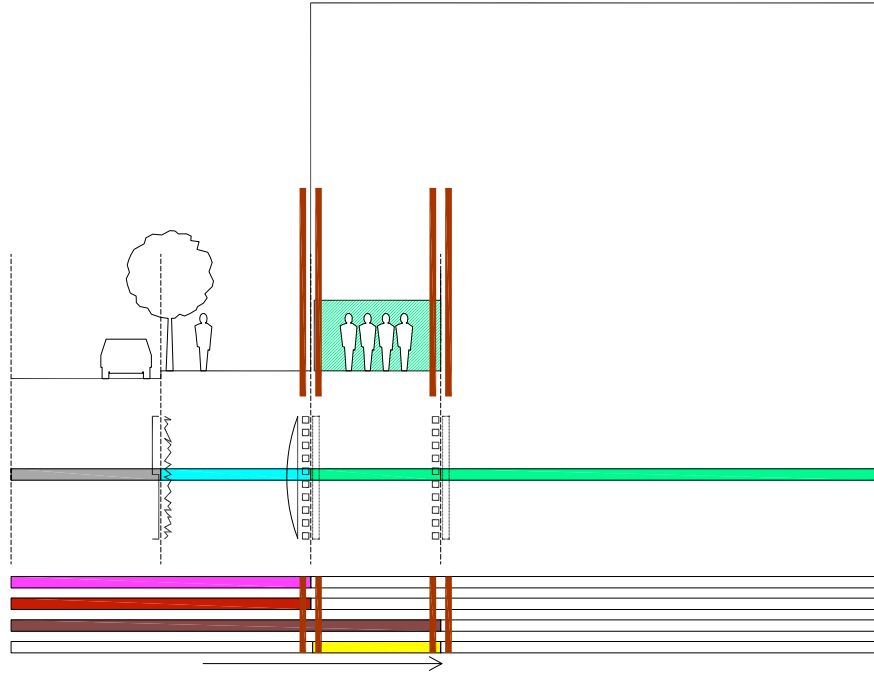

Kris Scheerlinck, doctoral candidate
 Universitat Ramon Llull, E.T.S.A. La Salle
 Barcelona, Spain, 2009-2010
Depth Configurations
 Proximity, Permeability and Territorial Boundaries in Urban Projects

- wall
- passway/door
- fence
- greenery
- topographic change
- technology
- change of pavement
- territorial boundary
- shared access

Illustrating Case Study: Williamsburgh, New York City, U.S.A.
 Site: North 5th Street

DEPTH AND ACCESS SCENARIOS
 base: in situ photographs & mapping

north ↑
 scale: graphic

CROSS SECTION 4

ACTIVITY

OPEN SPACE - BUILT SPACE
 NO RESTRICTED ACCESS - EXCLUSIVE ACCESS
 RESTRICTED ACCESS - EXCLUSIVE ACCESS
 DIFFERENTIAL COLLECTIVE SPACE
 VISUAL ACCESS

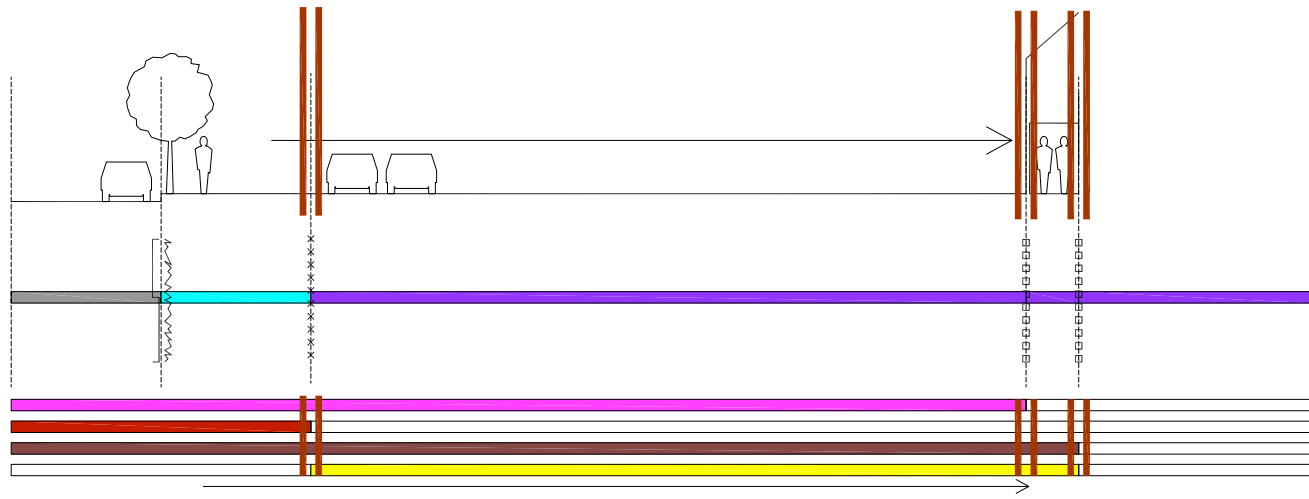

CROSS SECTION 5

ACTIVITY

OPEN SPACE - BUILT SPACE
 NO RESTRICTED ACCESS - EXCLUSIVE ACCESS
 RESTRICTED ACCESS - EXCLUSIVE ACCESS
 DIFFERENTIAL COLLECTIVE SPACE
 VISUAL ACCESS

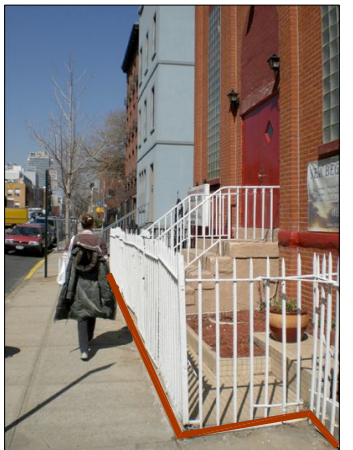
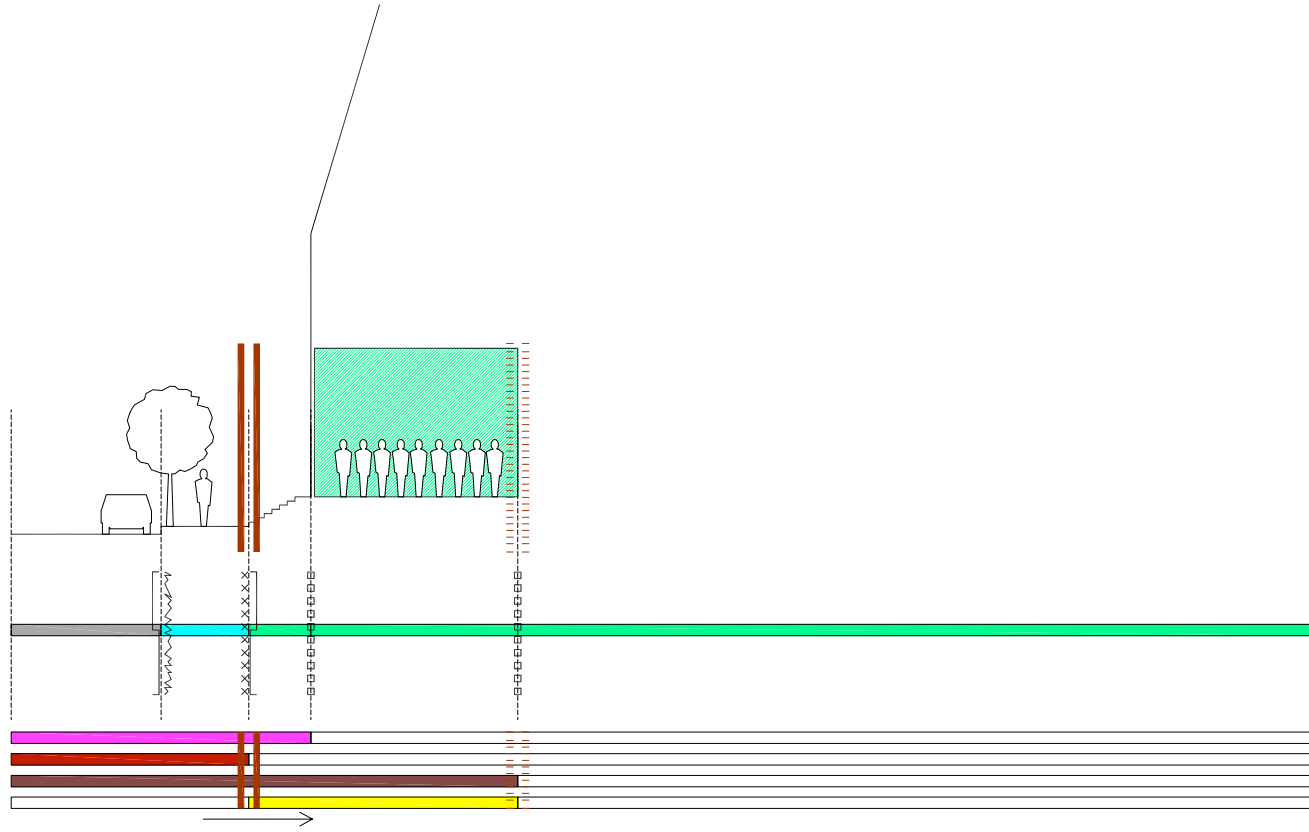

CROSS SECTION 6

ACTIVITY

OPEN SPACE - BUILT SPACE
 NO RESTRICTED ACCESS - EXCLUSIVE ACCESS
 RESTRICTED ACCESS - EXCLUSIVE ACCESS
 DIFFERENTIAL COLLECTIVE SPACE
 VISUAL ACCESS

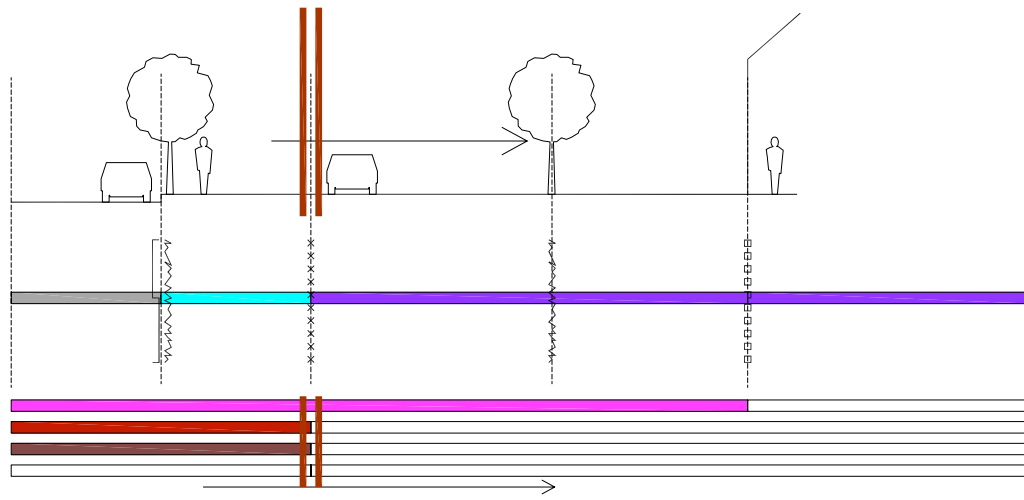

Kris Scheerlinck, doctoral candidate
 Universitat Ramon Llull, E.T.S.A. La Salle
 Barcelona, Spain, 2009-2010
Depth Configurations
 Proximity, Permeability and Territorial Boundaries in Urban Projects

- wall
- passway/door
- fence
- greenery
- topographic change
- technology
- change of pavement
- territorial boundary
- shared access

Illustrating Case Study: Williamsburgh, New York City, U.S.A.
 Site: North 5th Street

DEPTH AND ACCESS SCENARIOS
 base: in situ photographs & mapping

CROSS SECTION 7

ACTIVITY

OPEN SPACE - BUILT SPACE
 NO RESTRICTED ACCESS - EXCLUSIVE ACCESS
 RESTRICTED ACCESS - EXCLUSIVE ACCESS
 DIFFERENTIAL COLLECTIVE SPACE
 VISUAL ACCESS

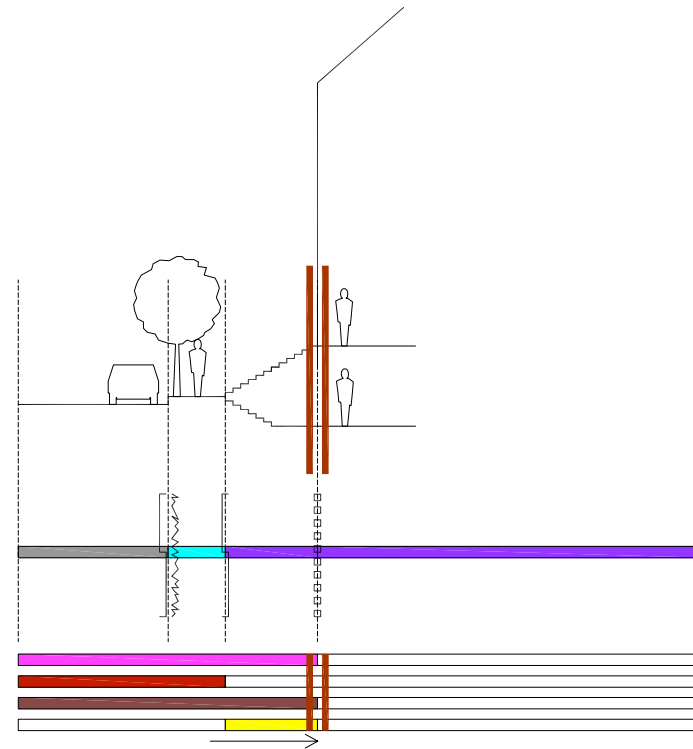

CROSS SECTION 8

ACTIVITY

OPEN SPACE - BUILT SPACE
 NO RESTRICTED ACCESS - EXCLUSIVE ACCESS
 RESTRICTED ACCESS - EXCLUSIVE ACCESS
 DIFFERENTIAL COLLECTIVE SPACE
 VISUAL ACCESS

